

ATTENTION PLEASE CHECK THE ULTRAFLO WEBSITE AT www.ultraflovalve.com TO ENSURE YOU HAVE THE MOST RECENT COPY OF THIS DOCUMENT

NOTES:

1. ALL DIMENSIONS IN INCHES
2. VALVE WITH FULLCUT DISC CARRIES A PRESSURE RATING OF 150 P.S.I.
3. VALVE O.D. AND FLANGE BOLT CIRCLE MUST SHARE COMMON CENTER LINE. VALVE DESIGN TO BE PLACED BETWEEN ANSI 125 OR 150 LB FLANGES (NOT FOR USE WITH ASA 250 OR 300 LB FLANGES).
4. TEFLON LINED VALVES ARE UNSUITABLE FOR SLIP-ON FLANGES
5. Q DIMENSION: IS THE MINIMUM FLANGE OR PIPE I.D. TOLERABLE FOR PROTECTION OF DISC SEALING EDGE WHILE OPERATING CENTERED BETWEEN FLANGES.
6. THE 8", 10" AND 12" HAVE STANDARD TOP PLATES.

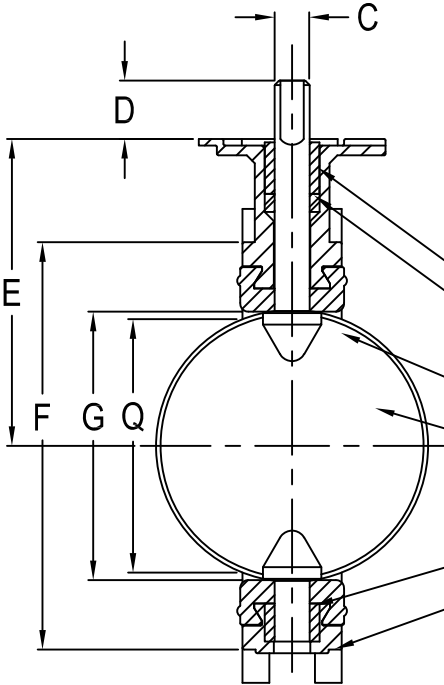
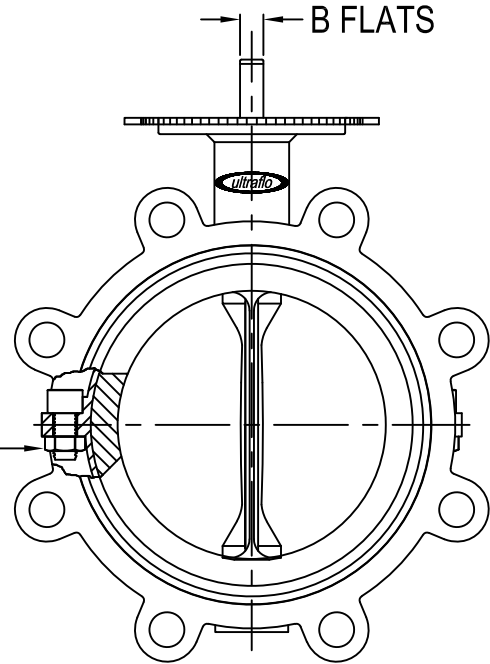
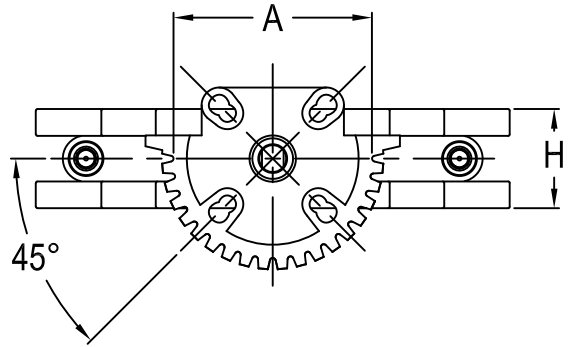

BODY SCREWS AND NUTS 2

NAME	NUMBER REQUIRED	MATERIAL	PART NUMBER
UPPER BUSHING	1		
PACKING	1		
SEAT	1		
DISC-STEM	1		
LOWER BUSHING	1		
BODY	1		

VALVE DIMENSIONS											TAPPED LUG DATA			TOP PLATE DRILLING					
SIZE	A	B	C	D	E	F	G	H	Q	WT. LBS	B. CIRCLE	HOLES	TAP	ISO DRILLING			STD DRILLING		
														B. CIRCLE	HOLES	HOLE DIA.	B. CIRCLE	HOLES	HOLE DIA.
2	4.000	.375	.563	1.250	4.063	4.125	2.000	1.625	1.313	6.000	4.750	4	.625-11UNC	2.760	4	.375	3.250	4	.438
3	4.000	.375	.563	1.250	5.000	5.375	3.000	1.750	2.563	8.000	6.000	4	.625-11UNC	2.760	4	.375	3.250	4	.438
4	4.000	.438	.625	1.250	6.000	6.875	4.000	2.000	3.563	13.000	7.500	8	.625-11UNC	2.760	4	.375	3.250	4	.438
6	4.000	.500	.750	1.250	6.625	8.750	5.750	2.125	5.438	18.000	9.500	8	.750-10UNC	2.760	4	.375	3.250	4	.438
8	6.000	.625	.875	1.250	8.313	11.000	7.750	2.500	7.438	35.000	11.750	8	.750-10UNC	4.020	4	.438	5.000	4	.563
10	6.000	—	1.125	2.000	9.125	13.375	9.750	2.500	9.531	55.000	14.250	12	.875-9UNC	4.020	4	.438	5.000	4	.563
12	6.000	—	1.125	2.000	10.625	16.125	11.750	3.000	11.500	75.000	17.000	12	.875-9UNC	4.020	4	.438	5.000	4	.563

10" AND 12" C SIZE STEM CONNECTION DIAMETER WITH 1/4" X 1/4" KEYWAY.

ZONE	REV	DATE	BY	APP'D	ECN	DESCRIPTION
A1	3	09/25/19	TAL	JPL		LUG WAS WAFER (DWG ERROR)
A1	2	05/06/10	DSS	CJH	374	UPDATED TITLEBLOCK
E4	1	07/06/09	CJH	CJH		ADDED TEFLON NOTE

Ultraflo Corporation
A Subsidiary of Bray International, Inc.

#8 Trautman Ind. Dr.
Ste. Genevieve, Mo.
63670 800-950-1762

DRAWN BY	NAME	DATE
TJM	TJM	05/25/98
CHECKED	TJM	05/28/98

2"-12" 392 SERIES VALVE

PART: 392 VALVE INVESTMENT CAST LUG BODY, ONE-PIECE DISC-STEM, PTFE, EPDM, NITRILE, VITON, BUNA SEAT

ECN: DWG: 399/392-5